

POLE CLAMP ASSEMBLY  
PEDESTRIAN CLAMP TYPE  
NTS

1-1/2" x 6" DR 12" LONG AS REQ'D  
TRAFFIC SIG. HEAD INSTAL.

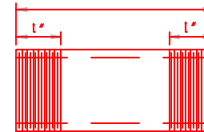

STD. 1-1/2" NIPPLE  
MTL: ALUM ALLOY 6061-T6 ASTM B-241

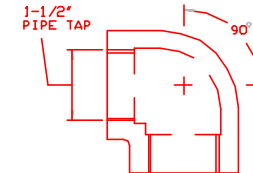

ELBOW  
MTL: ALUM. ALLOY 443.0

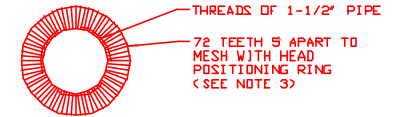

THREADS OF 1-1/2" PIPE  
72 TEETH 5 APART TO  
MESH WITH HEAD  
POSITIONING RING  
(SEE NOTE 3)

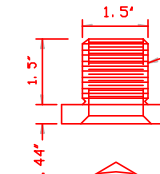

1-1/2" CHASE NIPPLE  
MTL: BRZ. 85-5-5-5  
NTS



NIPPLE, ELBOW AND/OR CHASE NIPPLE  
TO BE USED WITH HINGE STRAP OR  
PEDESTRIAN CLAMP AS REQUIRED.

PEDESTRIAN CLAMP DIMENSIONS			
A	B	C	BOLT LGTH.
6' - 8'	1.25'	2.3'	7.5'
8' - 10'	1.25'	2.5'	7.5'
10' - 12'	1.5'	2.875'	9.5'

PEDESTRIAN CLAMP LIST OF MATERIALS		
DESCRIPTION	MATERIAL	NO. REQ'D
PLAIN CLAMP	ALUM ALLOY 443.0	2
OUTLET CLAMP	ALUM ALLOY 443.0	2
BOLT, HEX HD. 1/2" x 7.5'	STN. STL.	4
LOCK WASHER 1/2"	STN. STL.	4
FLAT WASHER 1/2"	STN. STL.	8
HEX NUT 1/2"	STN. STL.	4
SET SCREW, SQ. HD. 1/4-20 x 5/8'	STN. STL.	2
1-1/2" CHASE NIPPLE	BRZ. 85-5-5-5	2
90 SERRATED ELBOW	ALUM ALLOY 443.0	2
STD. 1-1/2" NIPPLE x LG	ALUM. 6061-T6	2

NOTE:

HARDWARE SHALL BE TIGHTENED AS PER TORQUE RATING  
AS RECOMMENDED BY THE MANUFACTURER.

NJDOT PEDESTRIAN CLAMP ASSEMBLY

Signal Control Products, Inc.  
199 Evans Way, Branchburg, NJ 08876-4600  
Ph: 908-231-1133 Fax: 908-707-0333