



ROUND TAPERED ALUMINUM

ORDERING INFORMATION

FOR TOP OR SIDE FIXTURE MOUNTING

The following information illustrates the correct way to enter an order for RTA5M20NA5XXV. The ordering designation is detailed as follows.

Round	Tapered	Aluminum	Shaft Dia. (at base)	Wall Thickness	Mounting Height (ft.)	Base Type	Finish	Fixture Mounting & Type	No. & Location of Arms	Arm Lengths	Accessories (Vibration Damper)
R	T	A	5	M	20	N	A	5	X	X	V

Mtg. Height (Ft.)	Catalog Number	Wall Thickness (In.)	Anchor Bolts	Shaft Taper (In.)	Bolt Proj. (In.)	Bolt Circle Dia. (In.)	Anchor Bolt D x AB x H (In.)	Net. Wt. (Lbs.)	EPA At Pole	EPA Top (Sq. Ft.)	EPA (Sq. Ft.) 18" Above Pole Top	80	90	100	80	90	100	Max. Fixture Load—Include Bracket (Lbs.)
MH				B	BP	BC	AB		80	90	100	80	90	100	80	90	100	
10	RTA4T10NA	.125	3	4 x 3	1 3/4	6 3/4	3/4 x 15 x 3	22	6.4	4.8	3.7	5.3	4.0	3.1	100			100
12	RTA4T12NA	.125	3	4 x 3	1 3/4	6 3/4	3/4 x 15 x 3	25	4.7	3.4	3.4	4.0	2.9	2.2	100			100
15	RTA4M15NA	.188	3	4 x 3	1 3/4	6 3/4	3/4 x 15 x 3	42	6.1	4.4	3.2	5.4	3.9	2.3	100			100
15	RTA5T15NA	.125	3	5 x 3	1 3/4	7 3/4	3/4 x 15 x 3	33	4.6	3.4	3.4	4.1	3.0	2.2	100			100
18	RTA5T18NA	.125	3	5 x 3	1 3/4	7 3/4	3/4 x 15 x 3	39	3.1	2.1	2.1	2.7	1.9	1.2	100			100
18	RTA6L18AA	.156	3	6 x 4	2 1/8	9-10	3/4 x 25 x 3	57	10.9	8.2	6.3	9.8	7.3	5.7	100			100
20	RTA5T20NA	.125	3	5 x 3	1 3/4	7 3/4	3/4 x 15 x 3	43	2.1	1.3	0.8	1.9	1.2	--	100			100
20	RTA5M20NA	.188	3	5 x 3	1 3/4	7 3/4	3/4 x 15 x 3	61	6.6	4.6	3.3	6.0	4.2	3.0	100			100
20	RTA6L20AA	.156	4	6 x 4	2 1/8	9-10	3/4 x 25 x 3	64	8.5	6.2	4.7	7.7	5.6	4.2	150			150
25	RTA6L25AA	.156	4	6 x 4	2 1/8	9-10	3/4 x 25 x 3	81	4.2	2.7	1.8	3.9	2.5	1.7	150			150
25	RTA7L25AA	.156	4	7 x 4	2 3/4	10 -11	1 x 36 x 4	96	8.3	6.0	4.5	7.7	5.5	4.1	150			150
25	RTA8L25AA	.156	4	8 x 4	2 3/4	11-12	1 x 36 x 4	106	12.6	9.4	7.2	11.6	8.7	6.7	200			200
30	RTA7L30AA	.156	4	7 x 4	2 3/4	10 -11	1 x 36 x 4	108	3.9	2.4	1.6	3.7	2.3	1.5	150			150
30	RTA8L30AA	.156	4	8 x 4	2 3/4	11-12	1 x 36 x 4	117	7.0	4.9	3.6	6.5	4.6	3.3	200			200
30	RTA8M30AA	.188	4	8 x 4	2 3/4	11-12	1 x 36 x 4	138	9.1	6.6	4.9	8.6	6.2	4.6	250			250
30	RTA0L30EA	.156	4	10 x 6	2 1/8	13 1/2	1 x 36 x 4	152	16.0	12.2	9.4	14.9	11.4	8.8	250			250
35	RTA8L35AA	.156	4	8 x 4	2 3/4	11-12	1 x 36 x 4	140	3.9	2.4	1.4	3.7	2.3	1.4	150			150
35	RTA8M35AA	.188	4	8 x 4	2 3/4	11-12	1 x 36 x 4	165	6.2	4.2	2.9	5.9	4.0	2.7	150			150
35	RTA0L35EA	.156	4	10 x 6	2 1/8	13 1/2	1 x 36 x 4	180	11.6	8.6	6.4	11.0	8.1	6.0	200			200
35	RTA0M35EA	.188	4	10 x 6	2 1/8	13 1/2	1 x 36 x 4	213	14.9	11.2	8.5	14.1	10.6	8.0	250			250
40	RTA8M40AA	.188	4	8 x 6	2 3/4	11-12	1 x 36 x 4	210	4.0	2.7	1.7	3.8	2.5	1.6	100			100
40	RTA0L40EA	.156	4	10 x 6	2 1/8	13 1/2	1 x 36 x 4	209	8.2	5.7	3.9	7.8	5.5	3.7	150			150
40	RTA0M40EA	.188	4	10 x 6	2 1/8	13 1/2	1 x 36 x 4	247	10.9	7.9	5.7	10.4	7.5	5.4	200			200
45	RTA0L45EA	.156	4	10 x 6	2 1/8	13 1/2	1 x 36 x 4	237	5.5	3.4	1.9	5.2	3.3	1.8	100			100
45	RTA0M45EA	.188	4	10 x 6	2 1/8	13 1/2	1 x 36 x 4	281	7.8	5.2	3.3	7.4	5.0	3.2	150			150
45	RTA0X45EA	.250	4	10 x 6	2 1/8	13 1/2	1 x 36 x 4	368	12.7	9.1	6.5	12.1	8.7	6.2	200			200
45	RTA2X45BA	.250	4	12 x 6	4 3/4	16	1 1/4 x 48 x 6	398	22.6	16.9	12.8	21.6	16.2	12.3	300			300
50	RTA0X50EA	.250	4	10 x 6	2 1/8	13 1/2	1 x 36 x 4	381	7.7	5.4	3.7	7.4	5.2	3.5	200			200
50	RTA2X50BA	.250	4	12 x 6	4 3/4	16	1 1/4 x 48 x 6	439	15.4	11.3	8.2	14.8	10.8	7.9	300			300

NOTES: All 25' and greater luminaire mounting height lighting standards have a factory installed vibration damper. The above is our standard offering. Where higher EPA/wind speed capability or mounting height is required, other shaft dimensions and/or wall thickness are available. Consult P&K representative for pricing and lead times. The above EPA capacities are based upon the 1985 American Association of State Highway and Transportation Officials Specification. Catalog item requires one set of anchor bolts with single nuts.

DRILLING PATTERN

BASE TYPE—STANDARD AND ALTERNATIVE

Pole Dia.	Non-Breakaway Bases		Breakaway Bases
	Standard	Alternate	Alternate
4	N	C, R	--
5	N	C, F, G, O, R	--
6	N	A, C, F, G, P, R	--
7	A	Q	1, 2, 3, 5
8	A	D, F, H, Q	1, 2, 3, 4, 5
10	E	A, D, F, L, V, Z	1, 2, 4, 6, 7
12	B	M	7, 8

NOTES: Please refer to Base Section regarding proper usage of break-away device.

ACCESSORIES (order separately)

C=Convenience Outlet
 E=GFI Convenience Outlet
 F=Vibration Pad
 G=Ground Lug
 V=Vibration Damper
 (Outlets are located 4' above base on same side as handhole, unless otherwise specified. Receptacle is included.)

MOUNTING OPTIONS (add as suffix)

Fixed Tenon (round pole)	Designation Number	O.D. (In.)	Length (In.)
	1	2 3/8	3 1/2
	2	2 3/8	4
	3	3 1/2	5
	5	3	4
	4	4	6

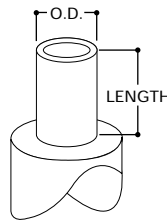

Luminaire drillings per manufacturer's template.

For details, drilling options, and locations of accessories, see Misc. catalog section.

Add appropriate letters to catalog number to indicate accessories desired.

Finish colors - anodize, paint or powder coat in a wide range of colors. See Misc. catalog section