

# BASES

## SHOE, TRANSFORMER HINGED

### MOUNTING AND TRANSFORMER BASES FOR ROUND ALUMINUM POLES

To determine bolt circles, bolt projection and/or anchorage dimensions, refer to the tables on the next page under the appropriate pole diameter and base type.

#### STANDARD BASES - BF

The bases shown below are standard bases for Type RTA poles. When ordering a pole with a standard base, the poles catalog number designates base to be supplied.

##### TYPE A

6", 7", 8", or 10" SB-2



##### TYPE B

12" SB-4



##### TYPE E

10" SB-4



##### TYPE N

4", 5", or 6" RB-1

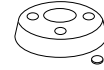

#### ALTERNATIVE BASES

##### TYPE C

4", 5", 6", or 10" SB-3

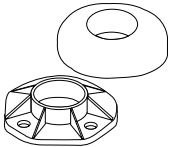

##### TYPE D

8" SB-4 or 10" SB-8

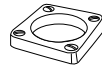

##### TYPE F

10" SB-2AF



#### TRANSFORMER BASES

When ordering a pole with a transformer base, the total mounting height includes the transformer base.

##### TYPE 3

7" or 8" SB-2 on TB1-17  
10" SB-2AF on TB1-17



##### TYPE 4

8" or 10" SB-4/TB1-17



##### TYPE 7

10" or 12" SB-8 on TB3-17



##### TYPE L

10" SB-2/TB-4



##### TYPE M

12" SB-4/TB-4

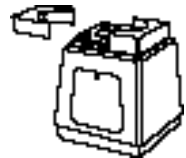

##### TYPE Q

7" or 8" SB-2/TB-2A



##### TYPE Z

10" SB-4/TB-2A



##### TYPE V

10" BA-1

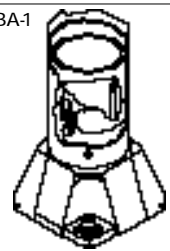

#### DECORATIVE BASES

##### TYPE F

5", 6", or 8" HBS



##### TYPE G

5" or 6" TBJ

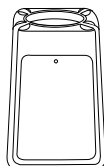

##### TYPE H

8" TB-1

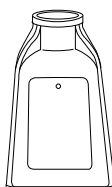

##### TYPE O

HBT-5

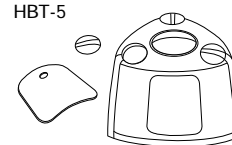

##### TYPE P

6" PB-1

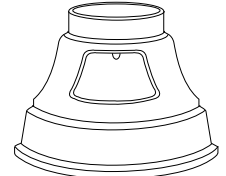

**DETAIL**

anged Base - BF

View of R Design Base

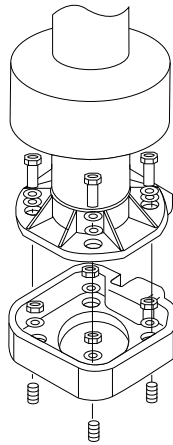
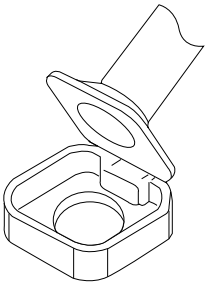

ases other than standard can be ordered (at an additional charge) by substituting the appropriate letter for the standard base letter in the catalog number.

**ORDERING INFORMATION**

Model No.	Base Type	No. of Bolts	Bolt Circle BC (In.)	Bolt Proj. BP (In.)	Anchor Bolts D x AB x H	Base Size (In.)	Net Wt. (Lbs.)
N		3	6 3/4	1 3/4	3/4 x 15 x 3	9 3/4 dia.	—
C		4	7	2	3/4 x 15 x 3	9 1/4 dia.	—
R		4	7 1/2	2 1/16	3/4 x 15 x 3	10 13/16 dia.	6
N		3	7 3/4	1 3/4	3/4 x 15 x 3	10 5/8 dia.	—
C		4	7 1/2	2	3/4 x 15 x 3	9 3/4 dia.	—
F		4	10	7	3/4 x 25 x 3	12 sq.	15
G		4	12 3/4	3	3/4 x 25 x 3	13 5/8 sq.	17
O		3	9	7	3/4 x 25 x 3	9 triangular	10
R		4	7 1/2	2 1/16	3/4 x 15 x 3	10 13/16 dia.	6
N		3	8 3/4	1 3/4	3/4 x 25 x 3	11 5/8 dia.	6
A		4	9-10	2 1/8	3/4 x 25 x 3	10 1/4 sq.	—
C		4	8 1/2	2	3/4 x 25 x 3	10 3/4 dia.	—
F		4	10	7	3/4 x 25 x 3	12 sq.	19
G		4	12 3/4	3	3/4 x 25 x 3	13 5/8 sq.	19
P		4	10	2 1/2	3/4 x 25 x 3	14 1/4 sq.	12
R		4	8 1/2	2 1/4	3/4 x 25 x 3	12 1/8 sq.	6
A		4	10-11	2 3/4	1 x 36 x 4	11 sq.	—
3		4	15	3	1 x 36 x 4	14 1/2 sq.	28
Q		4	15-17 1/4	3	1 x 36 x 4	16 sq.	35
A		4	11-12	2 3/4	1 x 36 x 4	12 sq.	—
D		4	12	2 1/2	1 x 36 x 4	12 7/8 sq.	3
F		4	12	7 1/4	1 x 36 x 4	13 7/8 sq.	25
H		4	15-16	3	1 x 36 x 4	17 sq.	34
3		4	15	3	1 x 36 x 4	14 1/2 sq.	28
4		4	15	3	1 x 36 x 4	14 1/2 sq.	28
Q		4	15-17 1/4	3	1 x 36 x 4	16 sq.	35
A		4	15-16	3 1/4	1 x 36 x 4	16 1/4 sq.	—
D		4	13 1/2 -15	2 3/4	1 x 36 x 4	15 sq.	—
E		4	13 1/2	2 1/8	1 x 36 x 4	12 15/16 sq.	—
F		4	13-15	3 1/4	1 x 36 x 4	12 15/16 sq.	—
3		4	15	3	1 x 36 x 4	14 1/2 sq.	28
L		4	18-20	3 3/4	1 1/4 x 48 x 6	18 1/4 sq.	86
V <sup>1</sup>		4	12-16	3 1/4	1 x 36 x 4	15 sq.	—
V <sup>2</sup>		4	15-16	3 1/4	1 1/4 x 48 x 6	15 sq.	—
Z		4	15-17 1/4	2 1/2	1 x 36 x 4	16 sq.	35
4		4	15	3	1 x 36 x 4	14 1/2 sq.	27
7		4	15-17 1/4	3	1 x 36 x 4	16 3/8 sq.	34
B		4	16	4 3/4	1 1/4 x 48 x 6	16 sq.	—
M		4	18-20	3 3/4	1 1/4 x 48 x 6	18 1/4 sq.	72
7		4	15-17 1/4	3	1 1/4 x 48 x 6	16 3/8 sq.	34

NOTES: <sup>1</sup> 40' Mounting Height. <sup>2</sup> 45' and 50' Mounting Height.

**THREE BOLT ANCHORAGE**

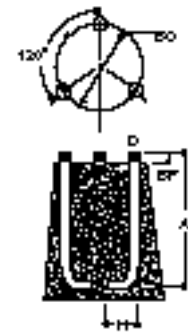

Handhole or base door orientated directly above anchor bolt.

**FOUR BOLT ANCHORAGE**

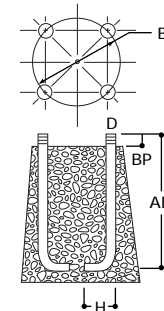

BC=Bolt Circle  
BP=Bolt Projection  
AB=Bolt Dimensions  
D=Bolt Diameter  
H=Bolt Dimension