

# BKTS

## BRACKETS ALUMINUM BRACKETS

### ALUMINUM BRACKETS FOR LUMINAIRES AND FLOODLIGHTS

Aluminum pole brackets are used for mounting  
luminaires or floodlights on aluminum poles.

#### ORDERING INFORMATION

Catalog Number	Figure	No. of Stubs	For Pole Top (In.)	Net Wt. (Lbs.)
T2A-4	2	2	4	9
T2B-4	1	2	4	8
T3A-4	3	3	4	16
T3B-4	4	3	4	14
T3C-4	5	3	4	15
T4A-4	9	4	4	21
T4B-4	6	4	4	17
T4C-4	7	4	4	19
T4D-4	8	4	4	19
T2A-6	2	2	6	12
T2B-6	1	2	6	11
T3A-6	3	3	6	19
T3B-6	4	3	6	17
T3C-6	5	3	6	18
T4A-6	9	4	6	24
T4B-6	6	4	6	20
T4C-6	7	4	6	22
T4D-6	8	4	6	22

#### TENON BRACKETS

Fig. 1—T2B

2 Tenons in line with uprights  
Capacity per tenon:  
EPA 8.8; Wt. 100 lbs.  
Bracket EPA: 0.9

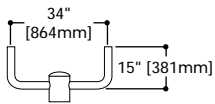

Fig. 4—T3B

3 Tenons at 120°, no uprights  
Capacity per tenon:  
EPA 6.8; Wt. 100 lbs.  
Bracket EPA: 0.6

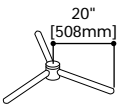

Fig. 7—T4C

4 Tenons at 90°, no uprights  
Capacity per tenon:  
EPA 6.5; Wt. 100 lbs.  
Bracket EPA: 0.9

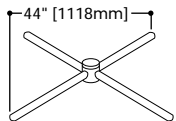

Fig. 2—T2A

2 Tenons at 180°, no uprights  
Capacity per tenon:  
EPA 7.3; Wt. 100 lbs.  
Bracket EPA: 0.5

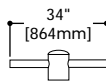

Fig. 5—T3C

3 Tenons at 120°, with uprights  
Capacity per tenon:  
EPA 8.3; Wt. 100 lbs.  
Bracket EPA: 1.1

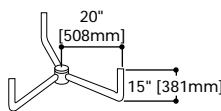

Fig. 8—T4D

4 Tenons at 90°, with uprights  
Capacity per tenon:  
EPA 8.3; Wt. 100 lbs.  
Bracket EPA: 1.5

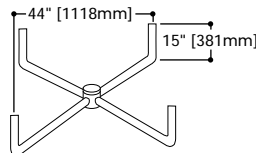

Fig. 3—T3A

3 Tenons in line with uprights  
Capacity per tenon:  
EPA 6.0; Wt. 100 lbs.  
Bracket EPA: 1.1

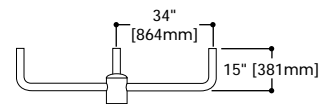

Fig. 6—T4B

4 Tenons with uprights  
Capacity per tenon:  
EPA 5.0; Wt. 100 lbs.  
Bracket EPA: 4.0

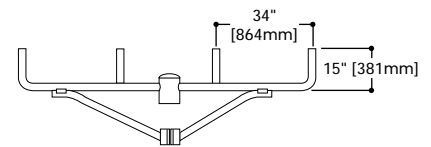
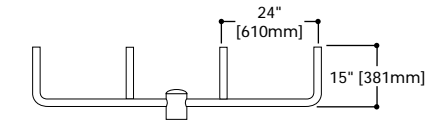

Fig. 9—T4A

4 Tenons in line with uprights  
Capacity per tenon:  
EPA 4.0; Wt. 75 lbs.  
Bracket EPA: 2.0



# Flagpoles, Inc.

## WOOD AND CONCRETE POLES

### Wood Poles

Catalog Number	Figure	Arm Length A (Ft.)	Arm Rise B (Ft.)	Bracket Net Wt. (Lbs.)	Max. Luminaire Wt. (Lbs.)	Max. Luminaire EPA
WE424	1	4	2	10	75	3.0
WE636	1	6	3	12	75	3.0
WEH836	1	8	3	16	75	3.0
WEHT636	2	6	3	25	75	3.0
WEHT836	2	8	3	29	75	3.0
WEHT1036	2	10	3	33	75	3.0
WEHT1236	2	12	3	37	75	3.0
WEHT1536	2	15	3	52	75	3.0
WP218	3	2	1	7	75	3.0
WP424	3	4	2	10	75	3.0
WP624	3	6	2	14	75	3.0

### Concrete Poles

Catalog Number	Figure	Arm Length A (Ft.)	Arm Rise B (Ft.)	Bracket Net Wt. (Lbs.)	Max. Luminaire Wt. (Lbs.)	Max. Luminaire EPA
CE424	4	4	2	12	75	3.0
CE636	4	6	3	14	75	3.0
CEH836	4	8	3	18	75	3.0
CEHT636	5	6	3	29	75	3.0
CEHT836	5	8	3	33	75	3.0
CEHT1036	5	10	3	37	75	3.0
CEHT1236	5	12	3	41	75	3.0
CEHT1536	5	15	3	56	75	3.0

### Wood and/or Concrete Poles

Catalog Number	Figure	Arm Length A (Ft.)	Arm Rise B (Ft.)	Bracket Net Wt. (Lbs.)	Max. Luminaire Wt. (Lbs.)	Max. Luminaire EPA
WCE424	7	4	2	10	75	3.0
WCE636	6	6	3	12	75	3.0
WCE836	6	8	3	29	75	3.0
WCE1036	6	10	3	31	75	3.0
WCE1236	6	12	3	37	75	3.0

### DECORATIVE BRACKET

C99623-G

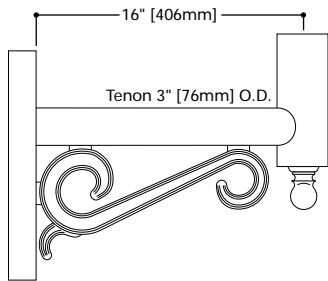

NOTE: Add "G" for grounding device.

